

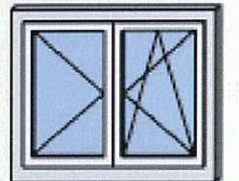

French casement window Tilt & Turn  
 SRW 280 - 800 for second opening Sash,  
 SRW 280 - 1300 for first opening Sash  
 SRH 500 - 2350  
 Rehau S921 Prestige Design



№	Turn only top hinge	№	Shootbolt top	
	52462 for PVC (5)		52505 Eurogroove 6/8/4 (18)	

⑳	№	Corner El.		
	52513	A	431 - 1650	370 - 2350
	52514	B	280 - 430	370 - 2350
	54796	C for night vent	400 - 1650	370 - 2350

№	Sissor Stay Hinge PVC	
52480	with positioning pin 3mm silver	(7)
52486	Rebated Sissor Stay Arm 12/20-13	(6)
94491	Spindle Bar	(8)

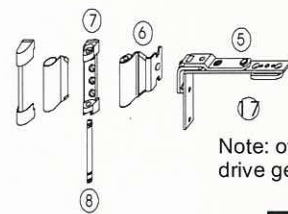

Note: over SRW 800mm you have to use french casement drive gears. Assembly shootbolt with centre look is not possible

№	Striker plates
34610	Striker (15)
95075	Sash lifter (16)

№	Compressed Middle Hinge
52480	Sissor Stay Hinge (7)
52486	Rebated Sissor Stay A. (6)
94491	Spindle Bar (8)
52321	Tilt only Hinge adjustable (26) or
94030	Til only Hinge for PVC Fix (27)
№	Option for windows Universal Compression device
52467	Sash Part (12)
35633	Frame part Rehau S921 (13)

Note: SRH 800 - 1750mm 1 Middle Hinges  
 SRH 1750 - 2350mm 2 Middle Hinges

№	Shootbolt bottom
52504	Eurogroove 6/8/4 (17)
41263	Spacer bar

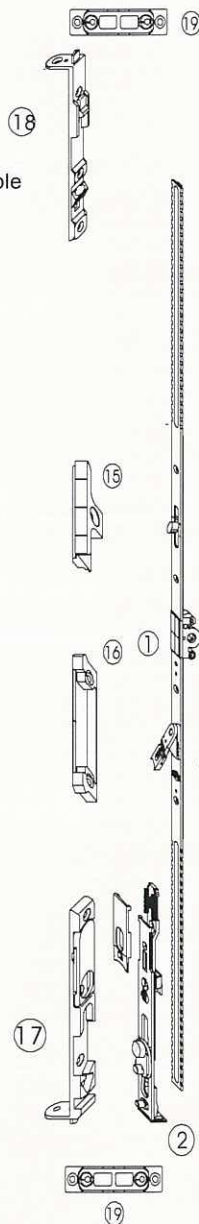
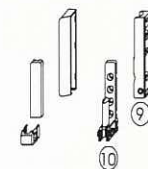
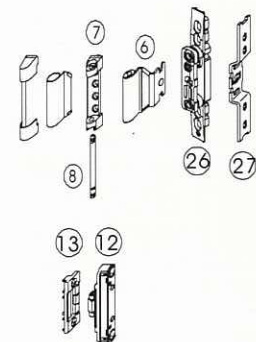

⑳	№	Rebated Sissor Stay		
		Size	FFB mm	
	52443	00	280 - 310	Corner Element B
	52443	00	400 - 430	Corner Element A+C
	52444	0	311 - 500	Corner Element B
	52444	0	431 - 600	Corner Element A+C
	52445	1	601 - 800	Corner Element A+C
	52446	2	801 - 1050	Corner Element A+C
	52447	3	1051 - 1300	Corner Element A+C
	52448	4	1301 - 1400	Corner Element A+C

⑳ Note: over SRW 1400 mm window (door 1100mm) or sash weight over 100 kg you must also use stabilizing stay 10596, Striker 54639

①	№	T & T-Drive Gear Var BS15 VHH		
	52422	Size 1 silver	var	500 - 650
	52423	Size 2 silver	var	601 - 900
	52425	Size 3 silver	var	901 - 1300
	52426	Size 4 silver	var	1300 - 1800
	for balkonery door			
	52427	Size 5 silver	var	1851 - 2350
	option balkonery door T&T Drive Gear lockable BS 30mm			
	59494	Size 5 BS 30mm silver	var	1851 - 2350

③	№	Centre Lock		
	54674	Size 400	751 - 1050	751 - 1050
	54675	Size 528	1051 - 1300	1051 - 1300
	54676	Size 628	1251 - 1500	1251 - 1500
	52457	Size 828		1501 - 1750
	52458	Size 1178		1751 - 1950
	59920	Size 1678		1951 - 2350

Note: over SRW + SRH 800mm you have to use centre looks

②	№	Tilt Lock Bolt	
	52432	for Windows	500 - 1800
	52433	for Doors	1801 - 2350

№	Striker plates
354970	Striker (14)
26460	Shoot Bolt Striker (19)
25449	Night vent Striker (25)

№	Corner Support
52478	3mm positioning pin (9)
№	Pivot Post
52483	3mm positioning pin (10)